

**TANK D'EMULSEUR SOUS PRESSION
ATMOSPHERIQUE**

POLYETHYLENE FOAM CONCENTRATE TANK

Mod. **SE-A-PE**

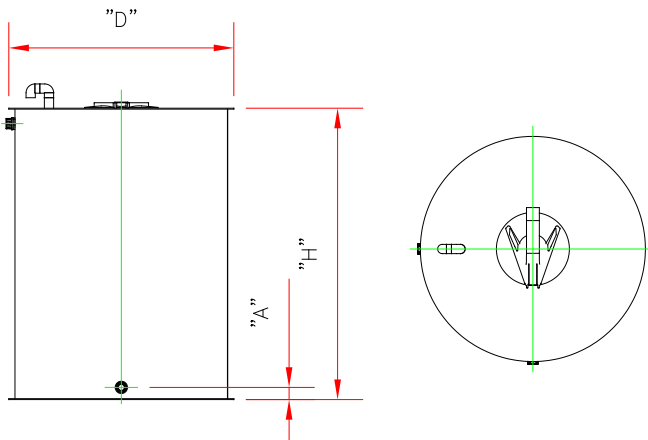
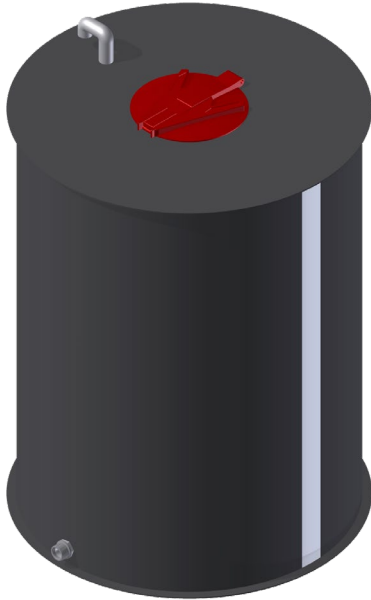

CARACTERÍSTICAS DE CONSTRUCCIONES

- Homopolymer polypropylène PPH, stabilisé aux UV
- Fini brillant beige clair
- Tête de fermeture et tube d'aspiration avec vis mâle 1" (selon la version)
- A utiliser pour du liquide de densité = < 1.4 kg/l.

OPTION

- Autres formes et accessoires, tels que niveaux, ouverture, vannes,...

NOTE

Les mesures et poids indiqués sont informatifs et peuvent évoluer selon le matériel servi.

CONSTRUCTION FEATURES

- Polyethylene PE100, UV stabilized.
- High resistance to chemicals.
- Closing Head and vacuum tube male thread 1". (depending on version)
- Suitable for liquid density = < 1.4 kg/l .

OPTIONAL

- Other shapes and accessories, such as levels, opening, valves...

NOTE

The measurements and weights indicated are informative and may change in the equipment served.

CAPACIDAD CAPACITY L	A mm.	DIAMETRO DIAMETER mm.	ESPESOR THICKNESS mm.	H mm.	PESO WEIGHT kg
135	80	477	4	750	11,5
300	80	637	4	1.000	15,7
500	80	955	6	750	27,1
1.000	80	955	6	1.500	43,8
1.400	80	955	6	2.000	59,5
2.000	80	1.300	6	1.500	93,5
2.400	80	1.430	8	1.500	102,3
3.000	80	1.430	8	1.900	114,8
4.000	80	1.430	10	2.500	156,5
4.800	80	1.430	10/12	3.000	182,6
6.000	80	1.600	10/12	3.000	234,8
8.500	80	1.910	12	3.000	323,5
12.750	80	1.910	12/15	4.500	407,0
20.000	80	2.540	12/20	4.000	605,2